

**PATERSON  
SIMONS**

A lifetime of support since 1948



# **IMPORTANT EQUIPMENT ANNOUNCEMENT**

**19 February 2019**

**Machines: All GMK Models with boom/rope  
guard strips or rollers**

**Content: Addition to the Operation Manual**

Paterson Simons has been advised by the Manitowoc Crane Company to communicate to GMK owners that the following additional instruction should be included in the supplied Operator's Manual for all GMK cranes with boom / rope guard strips or rollers.

The following sheets give extended instruction for the **protection of the main boom telescopic sections.**

Should you have any questions or complications, please contact Paterson Simons:

**[sales@patersonsimons.com](mailto:sales@patersonsimons.com)**

**+44 1273 625 969**

# 1

## Protection of the main boom telescopic sections

### 1.1

### Additional monthly maintenance work (M 1)

#### 1.1.1

#### Checking the guard strips

M 1

The figure shows the main boom on a GMK5250L truck crane. Other GMK models have a similar arrangement of guard strips (1) on the upper surface of the telescopic sections.

The guard strips (1) are *replaceable parts* that must be checked regularly.



#### Risk of damage to the telescopic sections and hoist rope!

The hoist rope can form grooves in the guard strips when the crane is used intensively. The hoist rope and telescopic section will be damaged when the groove depth reaches the metal of the telescopic section.

You must therefore turn or replace the guard strips in time (1).

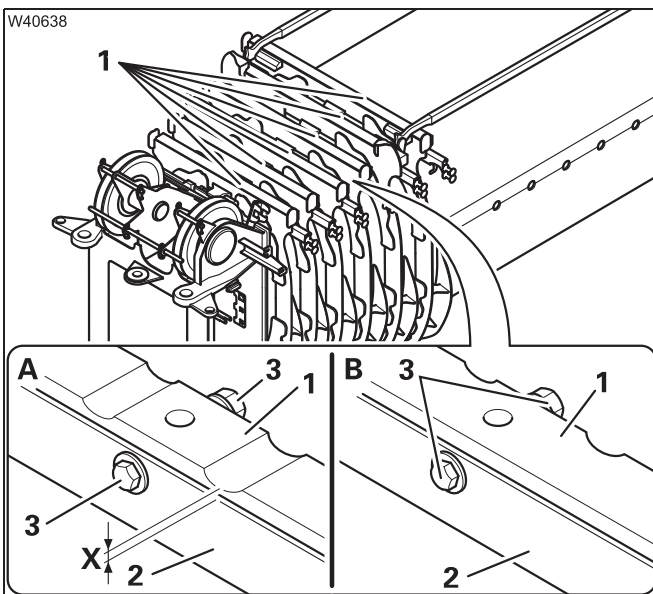

#### Check

- Check all guard strips (1) on all telescopic sections for damage, wear and formation of grooves by the hoist rope.

#### Turn if necessary

You can turn the guard strip, but only when the bottom of the groove lies significantly above (X) the telescopic section (2).

- (A) – Remove all screw connections (3).
- Remove the guard strip (1) and clean the guard strip and the top surface of the telescopic section.
- (B) – Turn the guard strip (1) by 90° and fasten all screw connections (3).



### When turning three times is no longer sufficient

- Have the damaged guard strips replaced by **Manitowoc Crane Care** or an authorised GROVE dealer or your qualified repair crew.

## 1.1.2

### Conversion from plastic guard strips to steel rollers

#### GMK 6300L-1

The GMK 6300L-1 truck crane is delivered **as standard** with steel rollers running in ball bearing races.

#### GMK 5250L and GMK 6300L

The GMK 5250L and GMK 6300L truck cranes can be delivered with/converted to steel rollers running in ball bearing races as **additional equipment**.

- Contact **Manitowoc Crane Care** for information on the details and cost of a conversion.

## 1.1.3

### Checking the steel rollers

**M 1**

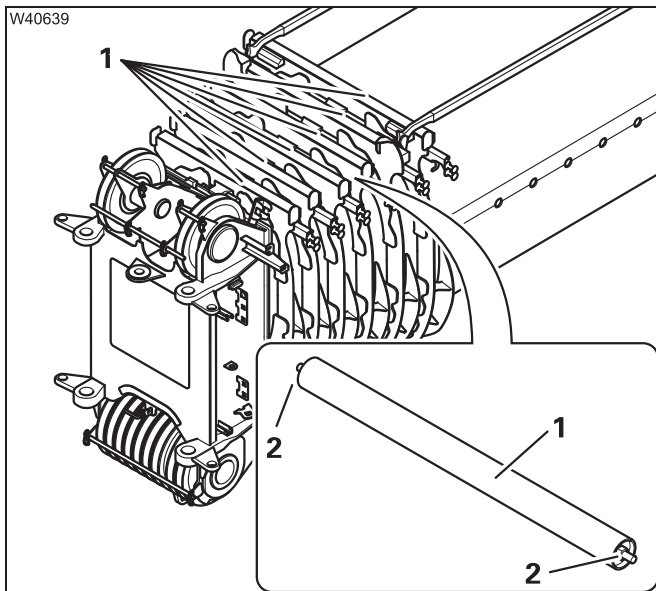

- Check all steel rollers (1) on all telescopic sections for damage, wear and mobility of the ball bearings (2).
- Have damaged, worn, stiff or extremely steel rollers replaced by **Manitowoc Crane Care** or an authorised GROVE dealer or your repair crew.